

CORNING

SRP: N961938L-rev02 BPEO S0

SRP: N961968H-rev01 ECAM S7 ROC-Round

SRP: N961991X-rev01 ECAM D18 CSM

Installation Instructions

BPEO-S0-MXT-04T1-D69-4S7

These installation instructions are provided as guidance for the trained craftsperson carrying out the installation
Ces instructions d'installation sont fournies à titre indicatif pour le technicien formé effectuant l'installation

Contents / Table des matières

1.	Recommended tools and accessories not included / Outils et accessoires recommandés non inclus	1
2.	Fixing / Fixation du boîtier	2
2.1	Wall mount or manhole / Facade ou chambre	2
2.2	Pole / Poteau	2
3.	Opening / Ouverture	2
4.	Main Distribution Cable / Cable Primaire	3
4.1	Cable Preparation	3
4.2	ECAM D18 Preparation	3
4.3	ECAM D18 Installation	3
4.4	ECAM S12 Preparation	4
4.5	ECAM S12 Installation	4
5.	Secondary Distribution Cable / Cables Secondaires	4
5.1	Cable Preparation	4
5.2	ECAM S7 DROP	4
5.3	ECAM S9,5 BRANCH	5
6.	Fibre Routing / Gestion des Fibres	5
6.1	Organizer routing / Cheminement dans l'organiseur	5
6.2	Red plastic kit using / Utiliser de l'outil de maintien	5
6.3	Splicing tray assembly / Assemblage des cassettes	6
6.4	Splicing tray identification / Identification des cassettes	6
6.5	Routing fibres in the tray / Cheminement des fibres dans les cassettes	6
6.5.1	Standard Tray / Cassette Standard	6
6.5.2	Tray Dual Zone / Cassette Bi-Zone	7
6.5.3	Tray 16 and 24 Fusions / Cassettes 16 et 24 Fusions	7
7.	Splitters Management / Gestion des Splitters	7
8.	Closing / Fermeture	7
9.	Securing and Identification / Sécurisation et Identification	8
10.	Flash Test / Test de Pression	8

1. Recommended tools and accessories not included / Outils et accessoires recommandés non inclus



4mm



8mm

-Pressure tool kit
-Leak detection fluid

-Kit de pressurisation
-Détecteur de fuites

-Suitable dowels and screws
-20mm steel band

-Erous et vis
-Bande métallique de 20mm

2. Fixing / Fixation du boîtier

2.1 Wall mount or manhole / Facade ou chambre

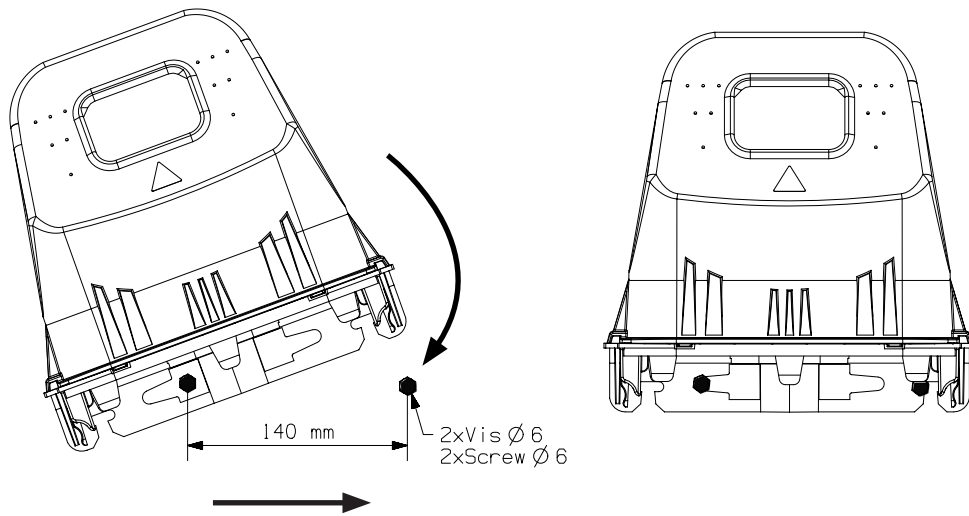

2.2 Pole / Poteau



3. Opening / Ouverture

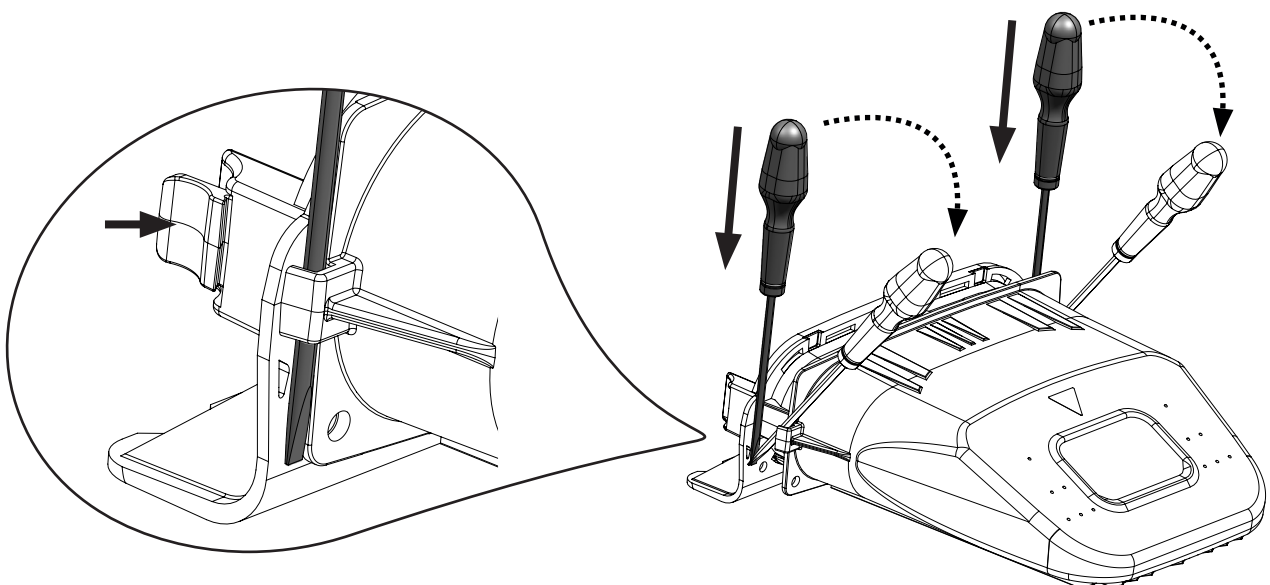

4. Main Distribution Cable / Cable Primaire

4.1 Micro-Structure Cabels Preparation / Preparation cable micro-structure

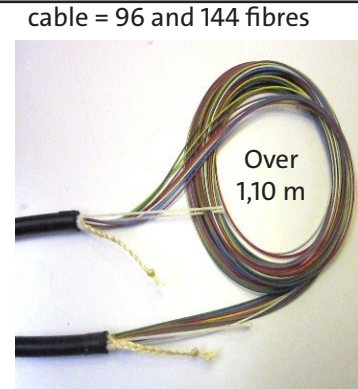
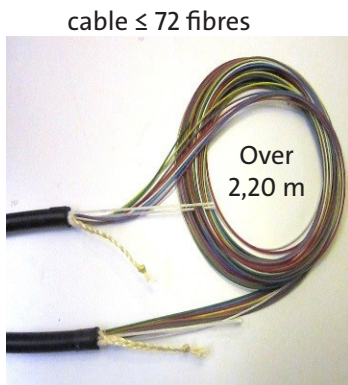

4.2 ECAM D18 Preparation

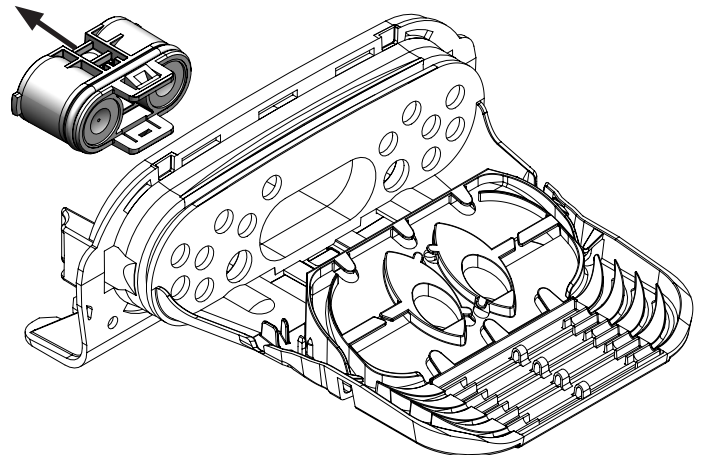
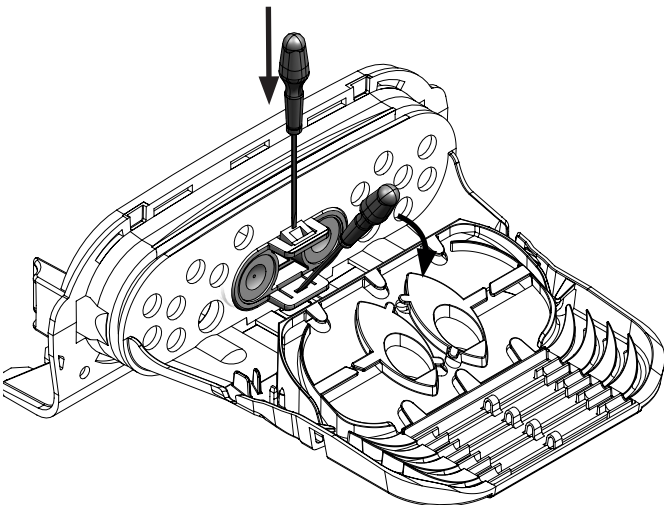

4.3 ECAM D18 Installation

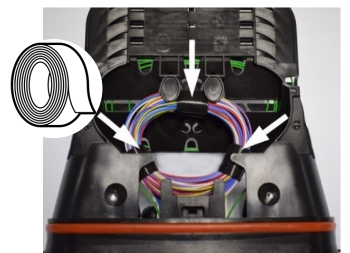
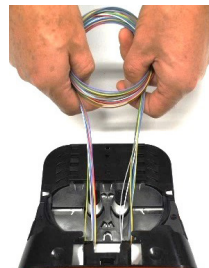
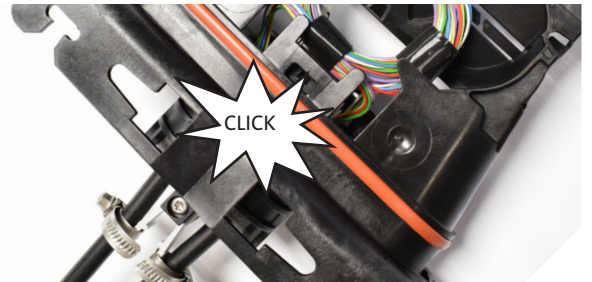
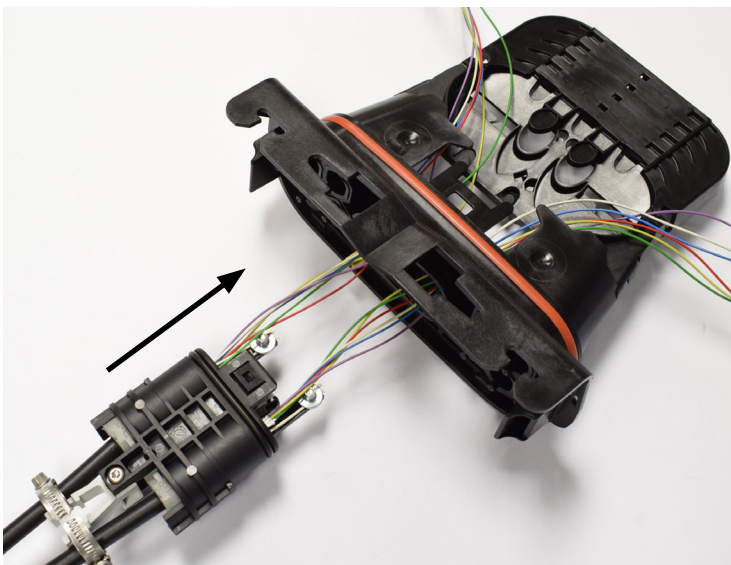

4.4 ECAM S12 Preparation

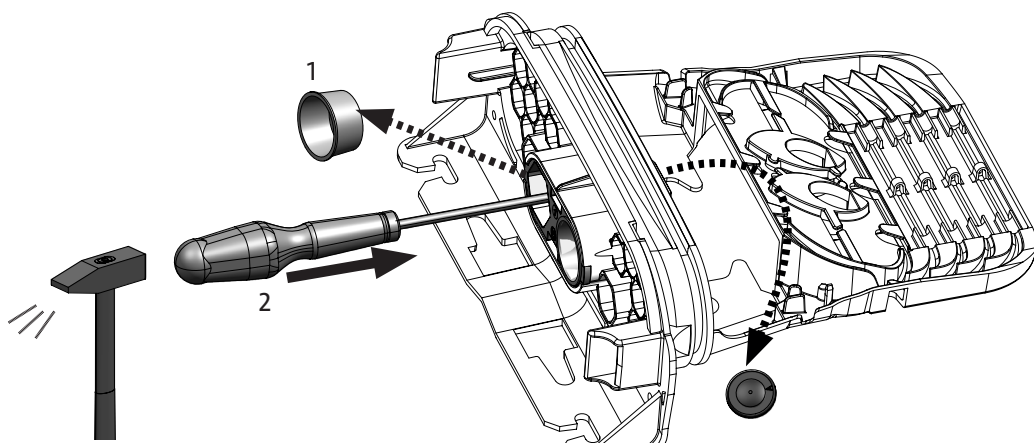

4.5 ECAM S12 Installation

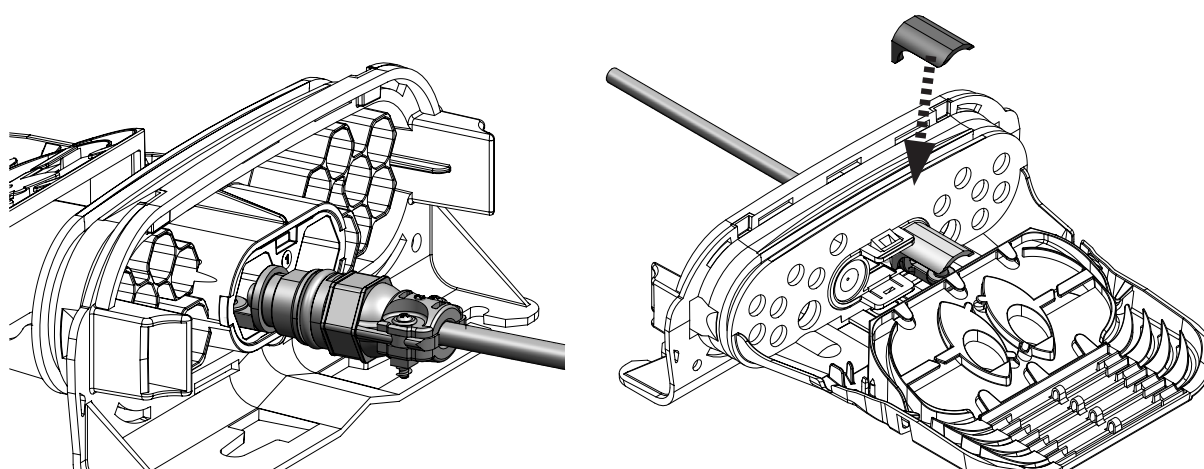

5. Secondary Distribution Cable / Cables Secondaires

5.1 Cable Preparation

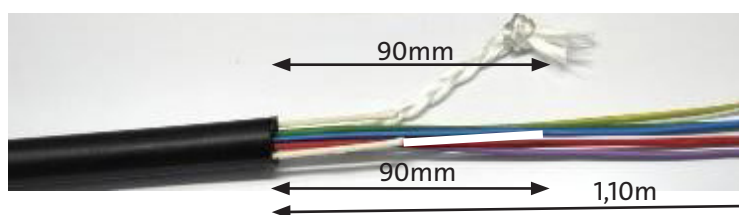

5.2 ECAM S7 DROP

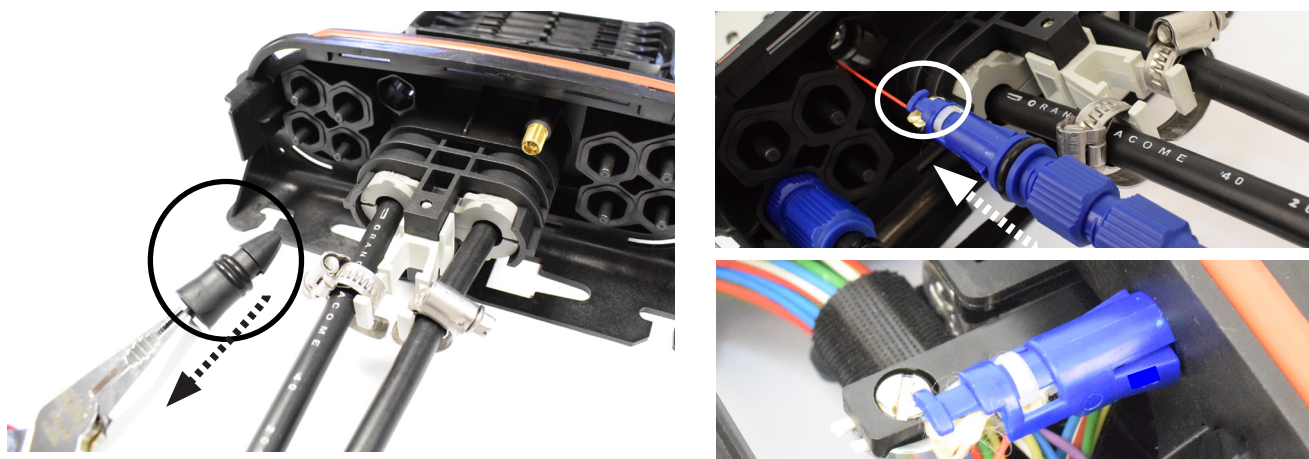

5.3 ECAM S9,5 BRANCH



6. Fibre Routing / Gestion des Fibres

6.1 Organizer routing / Cheminement dans l'organiseur

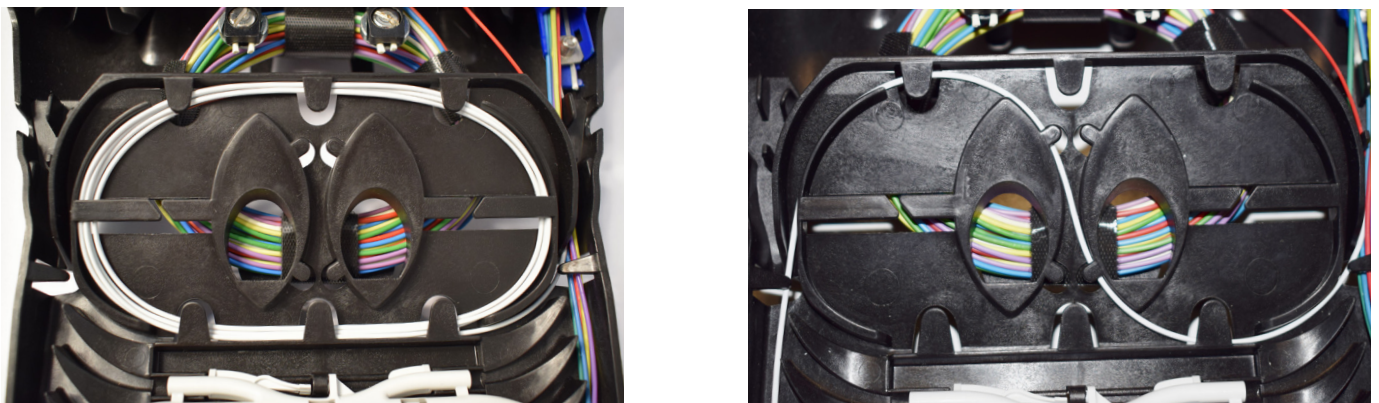

6.2 Red plastic kit using / Utilisation de l'outil de maintien

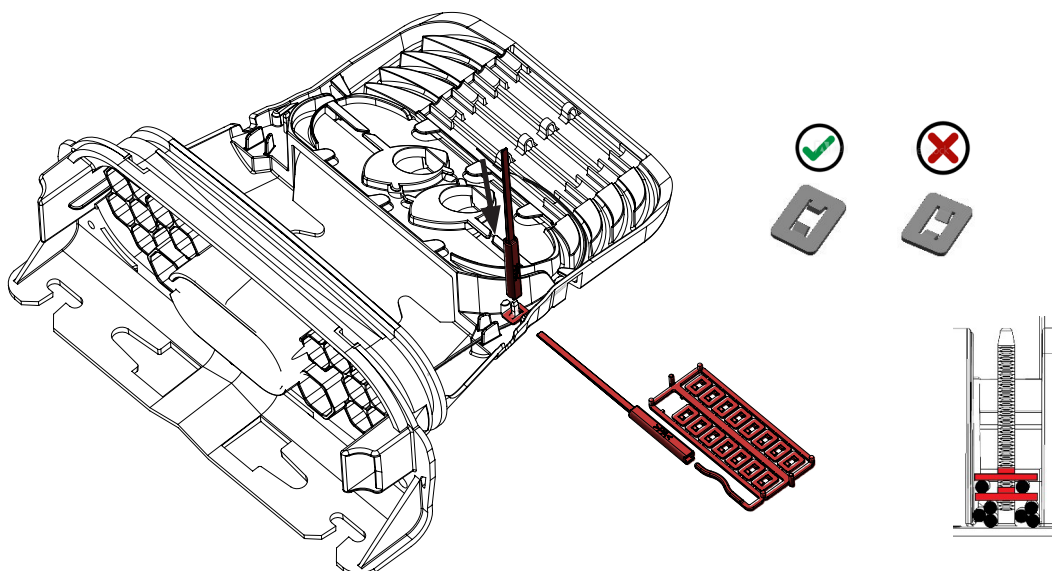

6.3 Splicing tray assembly / Assemblage des cassettes

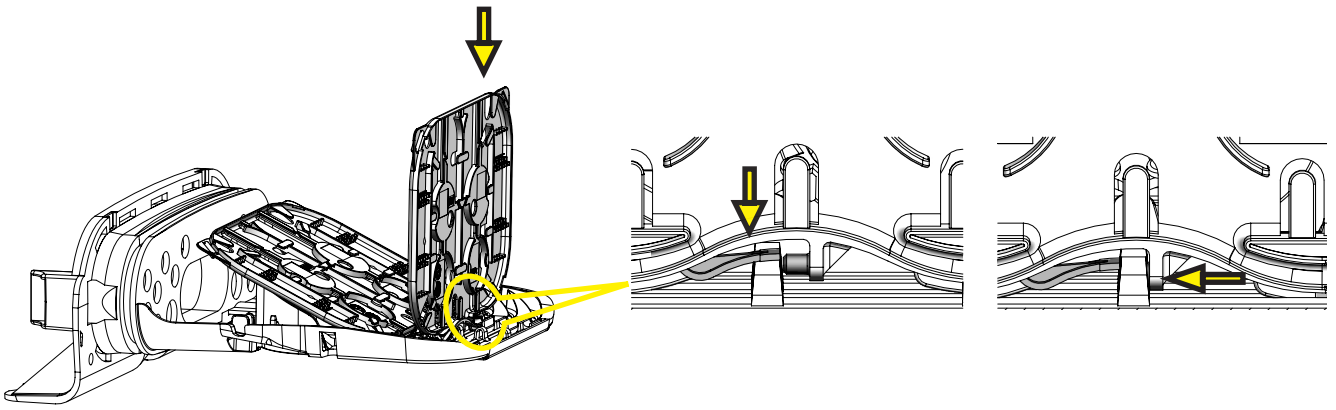

6.4 Splicing tray identification / Identification des cassettes

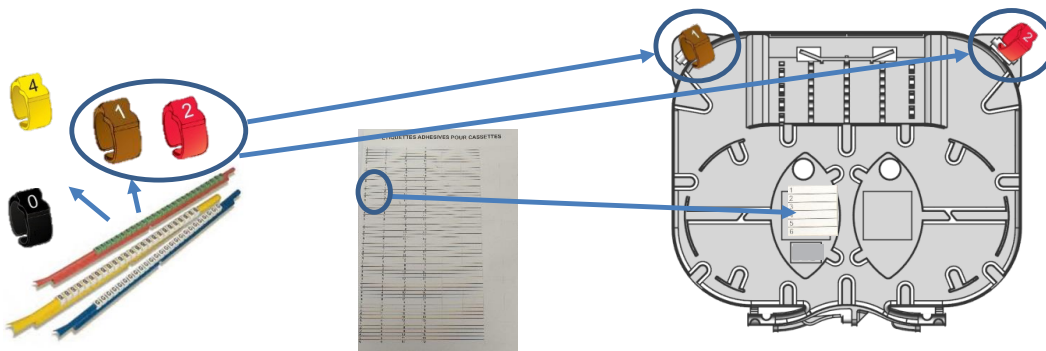

6.5 Routing fibres in the tray / Cheminement des fibres dans les cassettes

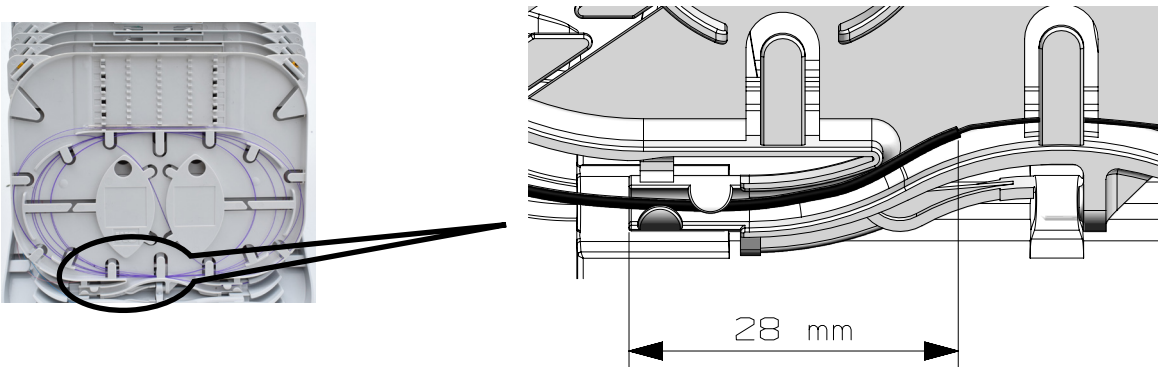

6.5.1 Standard Tray / Cassette Standard



6.5.2 Tray Dual Zone / Cassette Bi-Zone

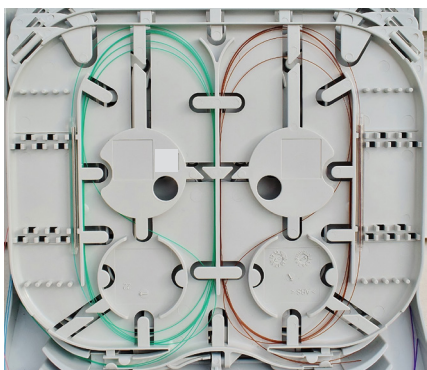

6.5.3 Tray 16 and 24 Heat Shrink Splice Protectors / Cassettes 16 et 24 Fusions

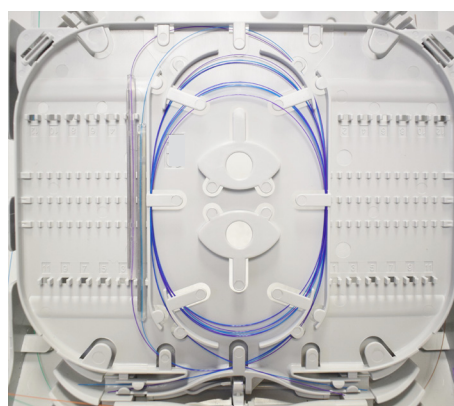
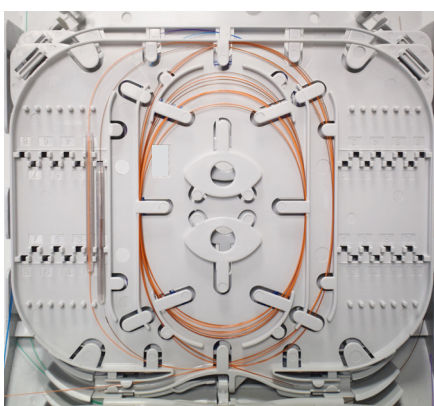

7. Splitters Management / Gestion des Splitters



8. Closing / Fermeture

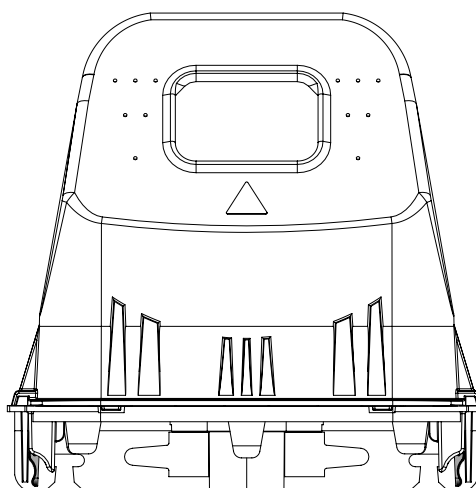
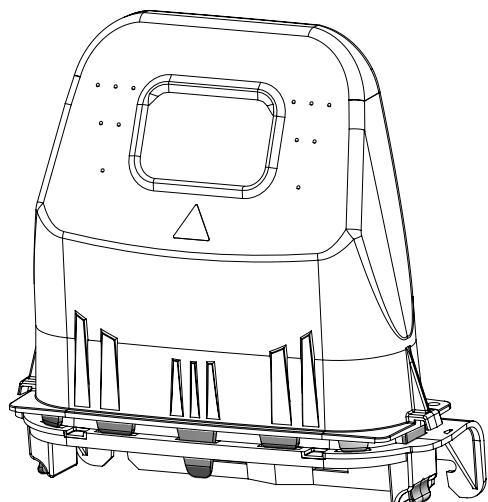

9. Securing and Identification / Securisation et Identification

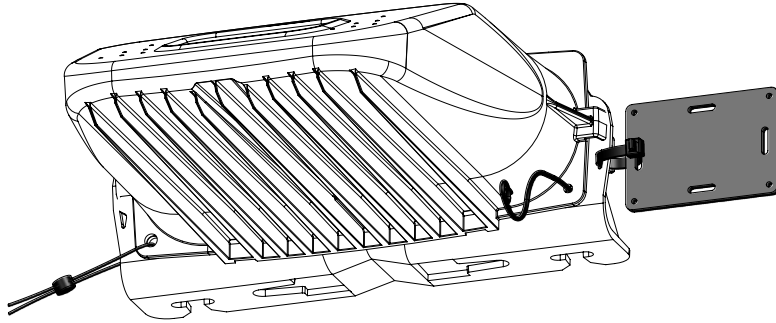

10. Flash Test / Test de Pression

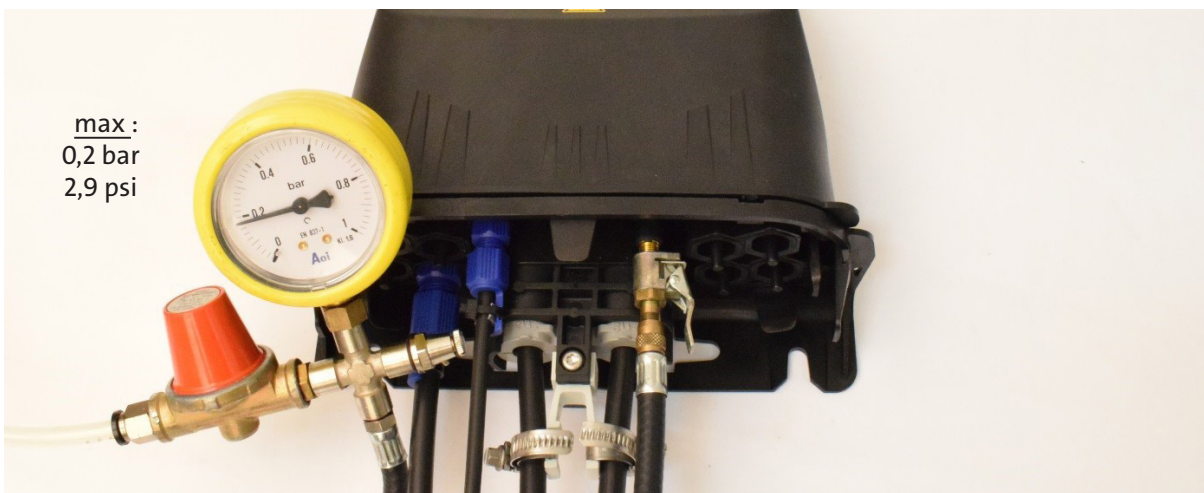

Corning Optical Communications GmbH & Co. KG • Leipziger Strasse 121 • 10117 Berlin, GERMANY

+00 800 2676 4641 • FAX: +49 30 5303 2335 • www.corning.com/opcomm/emea

Corning Optical Communications reserves the right to improve, enhance, and modify the features and specifications of Corning Optical Communications products without prior notification. A complete listing of the trademarks of Corning Optical Communications is available at www.corning.com/opcomm/trademarks. All other trademarks are the properties of their respective owners. Corning Optical Communications is ISO 9001 certified. © 2019 Corning Optical Communications.

All rights reserved. N961938L / December 2019

Corning Optical Communications se réserve le droit d'améliorer et de modifier les caractéristiques et spécifications des produits de Corning Optical Communications sans préavis. Une liste complète des marques de Corning Optical Communications est disponible sur www.corning.com/opcomm/trademarks. Toutes les autres marques sont la propriété de leurs propriétaires respectifs. Corning Optical Communications est certifiée ISO 9001. © 2019 Corning Optical Communications.

Tous droits réservés. N961938L/ Decembre 2019

CORNING

Installation Instructions

Instructions de montage

Issue 1, Oct 2020

Indice 1, Oct 2020

ECAM S7 ROC -Round cables

These installation instructions are provided as guidance for the trained craftsperson carrying out the installation
Ces instructions d'installation sont fournies à titre indicatif pour le technicien formé effectuant l'installation

1-Application with a ROC cable - Application avec un câble plat ROC

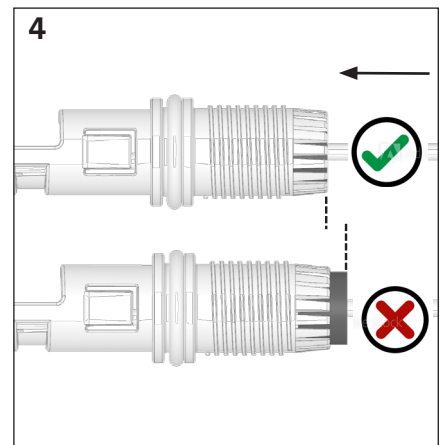
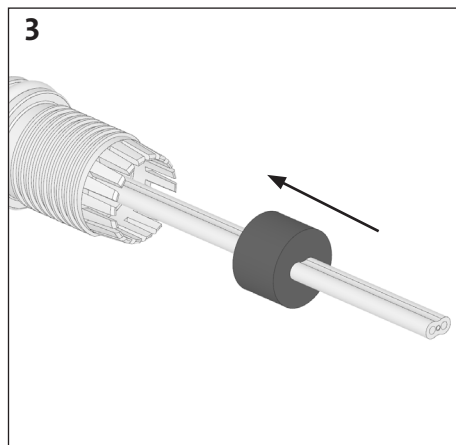
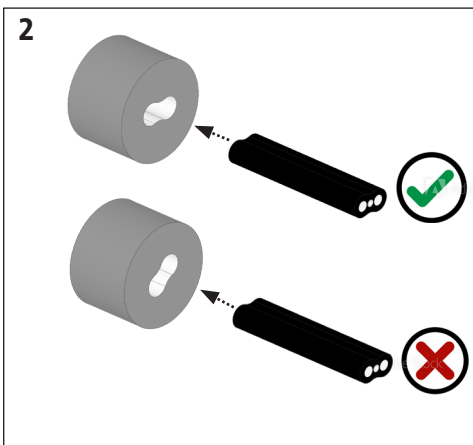
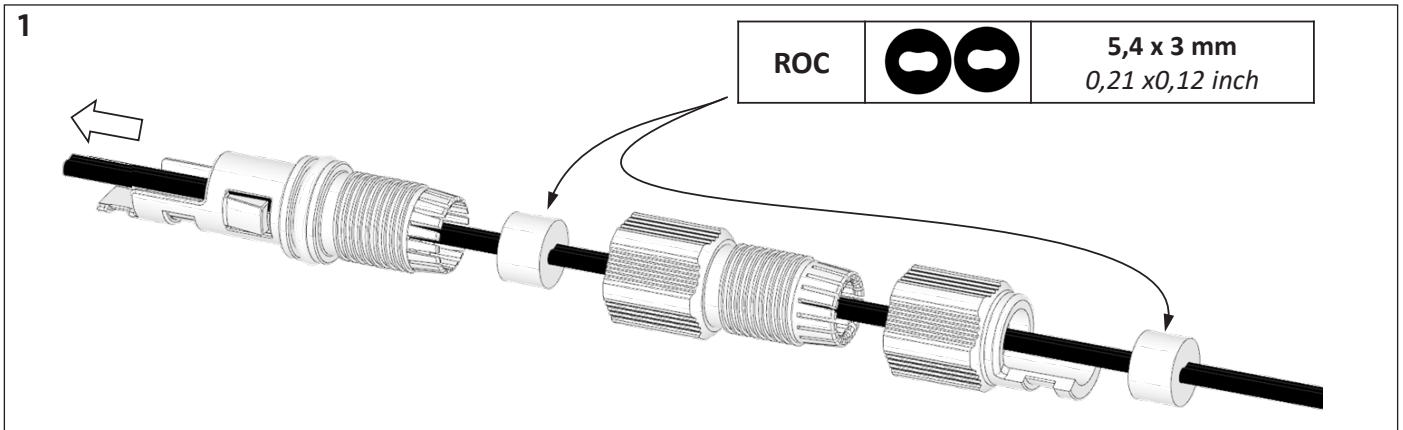
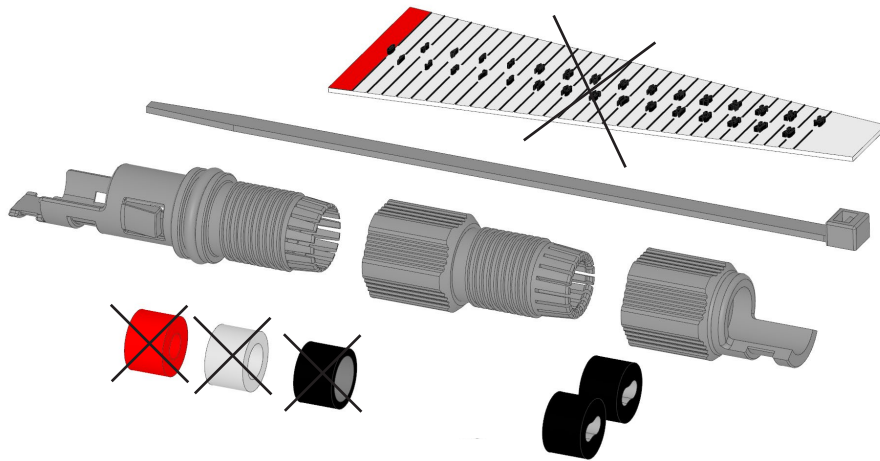

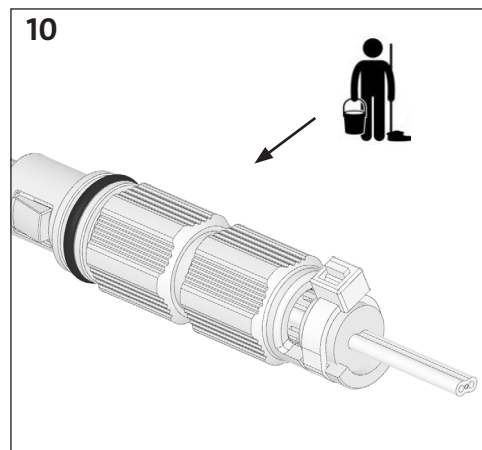
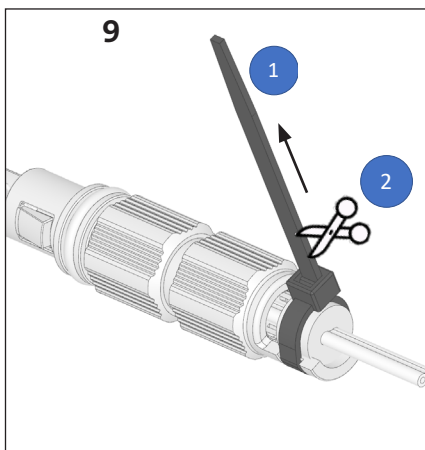
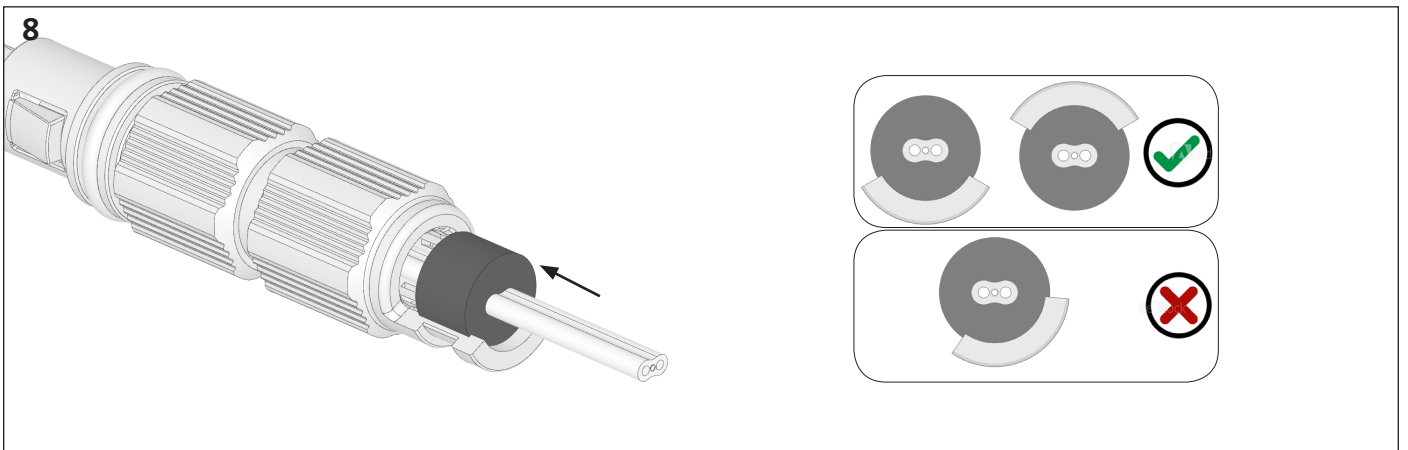
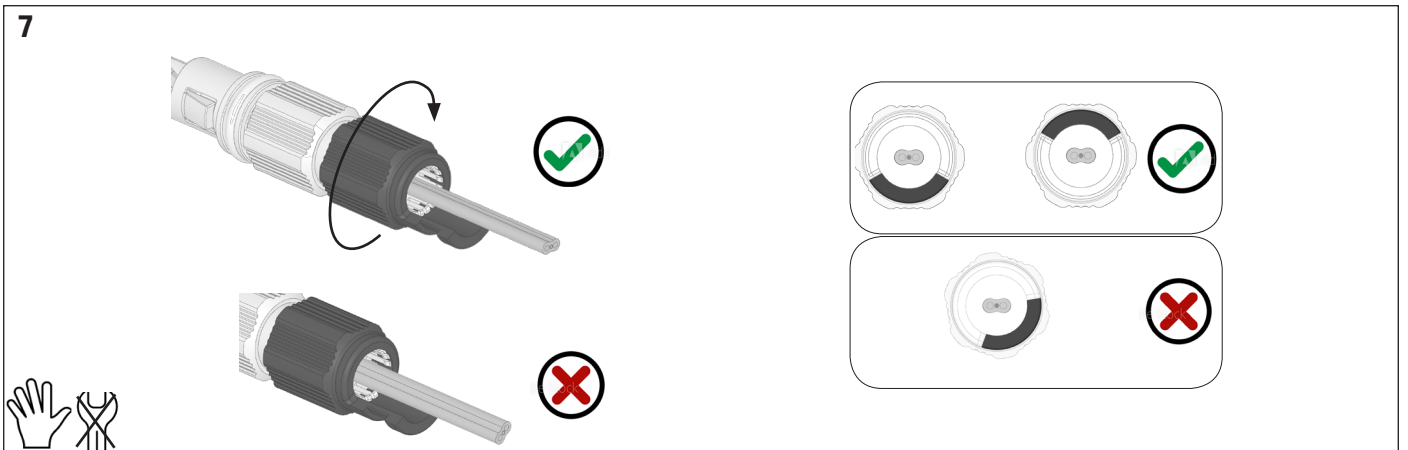
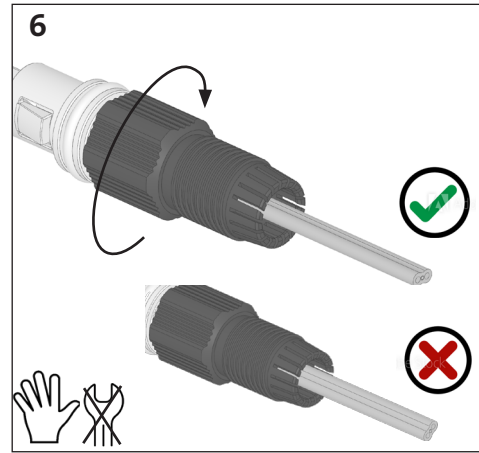
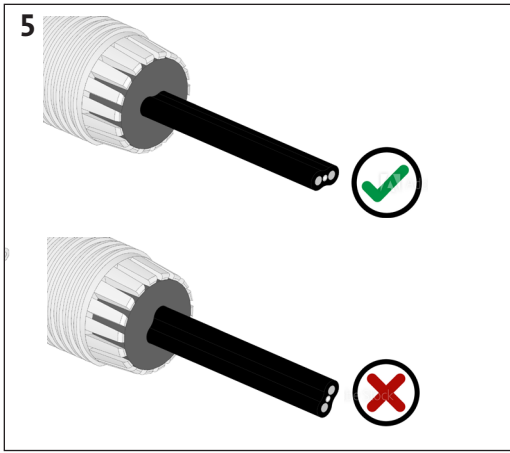

2-Application with a round cable -Application avec un câble rond

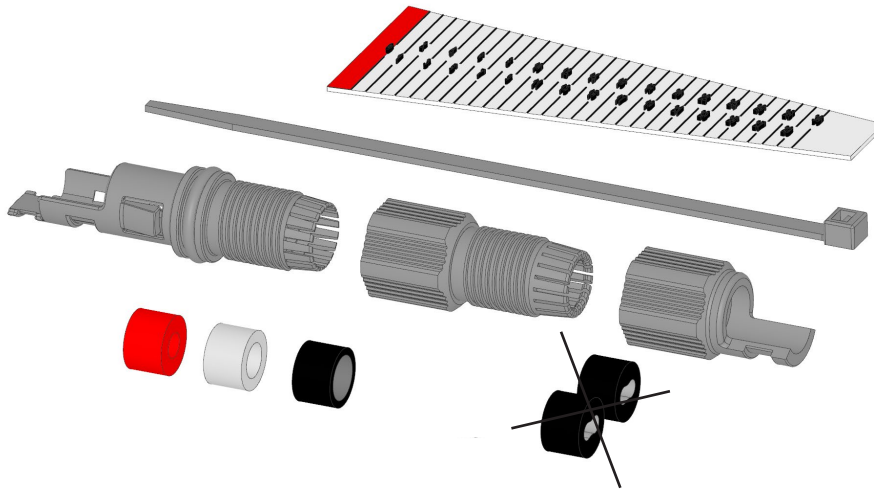

1

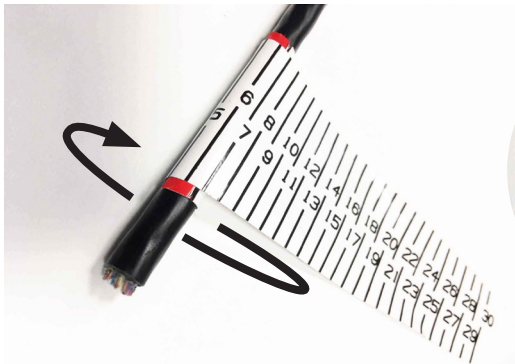

Exemple:

câble Ø 6,5 mm

2

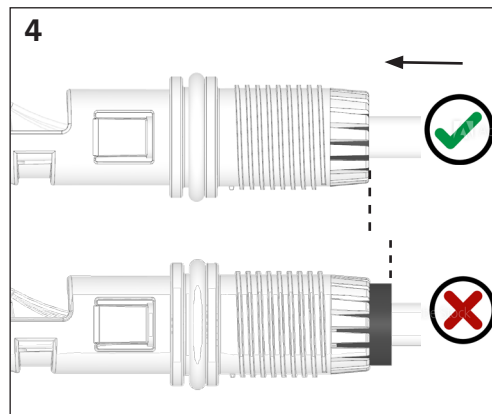
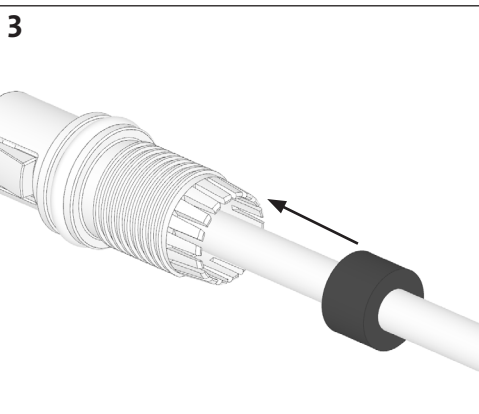
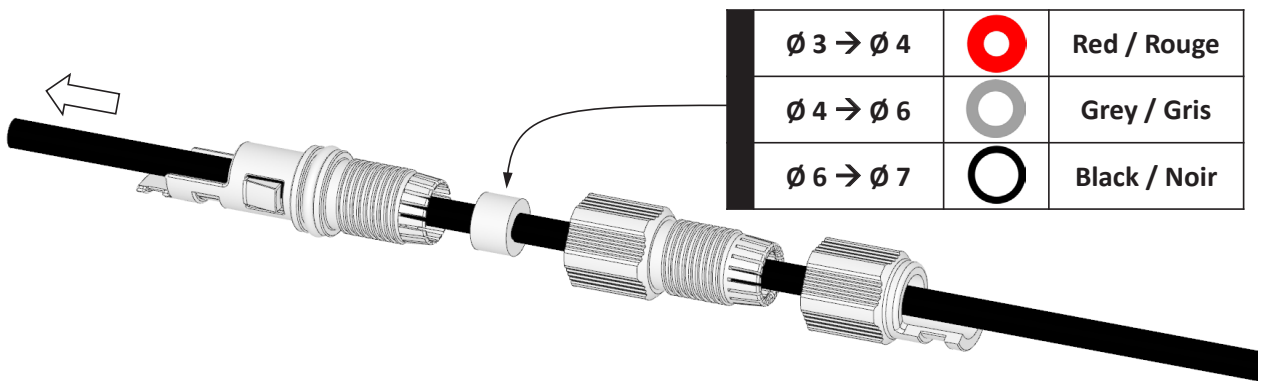

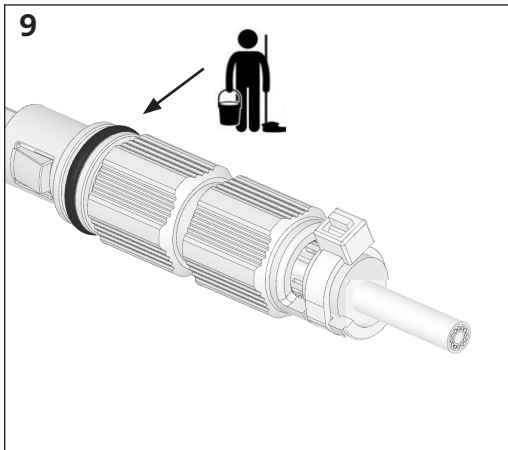
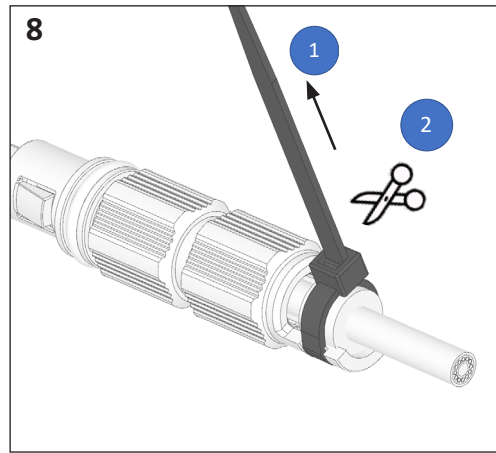
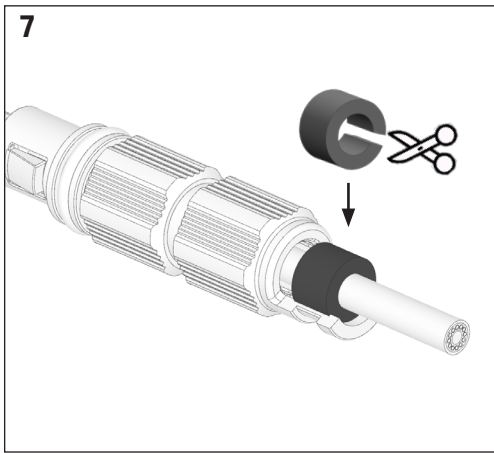
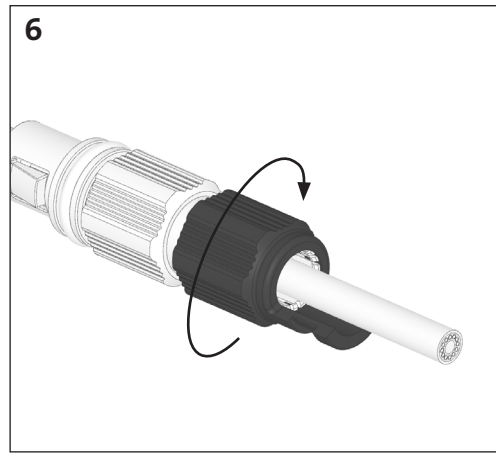
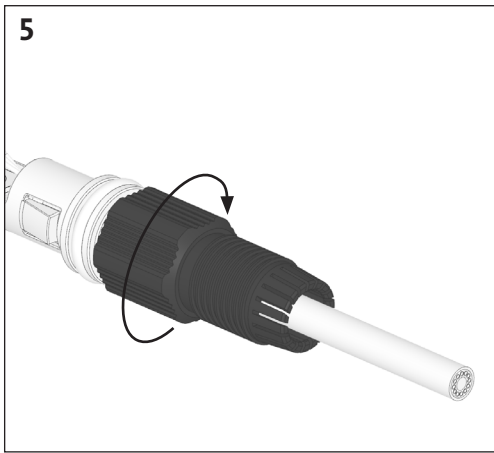

Corning Optical Communications GmbH & Co. KG • Leipziger Strasse 121 • 10117 Berlin, GERMANY

+00 800 2676 4641 • FAX: +49 30 5303 2335 • www.corning.com/opcomm/emea

Corning Optical Communications reserves the right to improve, enhance, and modify the features and specifications of Corning Optical Communications products without prior notification. A complete listing of the trademarks of Corning Optical Communications is available at www.corning.com/opcomm/trademarks. All other trademarks are the properties of their respective owners. Corning Optical Communications is ISO 9001 certified. © 2019 Corning Optical Communications.

All rights reserved. N961968H/ Oct2020

Corning Optical Communications se réserve le droit d'améliorer et de modifier les caractéristiques et spécifications des produits de Corning Optical Communications sans préavis. Une liste complète des marques de Corning Optical Communications est disponible sur www.corning.com/opcomm/trademarks. Toutes les autres marques sont la propriété de leurs propriétaires respectifs. Corning Optical Communications est certifiée ISO 9001. © 2019 Corning Optical Communications.

Tous droits réservés. N961968H/ Oct 2020

CORNING

Installation Instructions
Instructions de montage

Issue 1, Sept 2020
Indice 1, Sept 2020

ECAM D 18 CSM

These installation instructions are provided as guidance for the trained craftsperson carrying out the installation
Ces instructions d'installation sont fournies à titre indicatif pour le technicien formé effectuant l'installation

Recommended Tools-Outils recommandés

In addition to the usual tools recognized for work on optical networks, the following tools are also recommended:

- sheath cutter with retractable blade, screwdriver TORX Plus® no. 20 and no. 25, scissors, 13 mm pipe wrench.

Outre les outils habituels reconnus pour le travail sur les réseaux optiques, les outils suivants sont également recommandés:

- coupe-gaine à lame rétractable, tournevis TORX Plus® no. 20 and no.25, ciseaux, clé à tube 13 mm.

Stripping length Longueur de dénudage	
BPEO TO	2,20 m
BPEO T1	2,60 m
BPEO T1,5	2,60 m
BPEO T2	3,60 m
BPEO T3	4,40 m

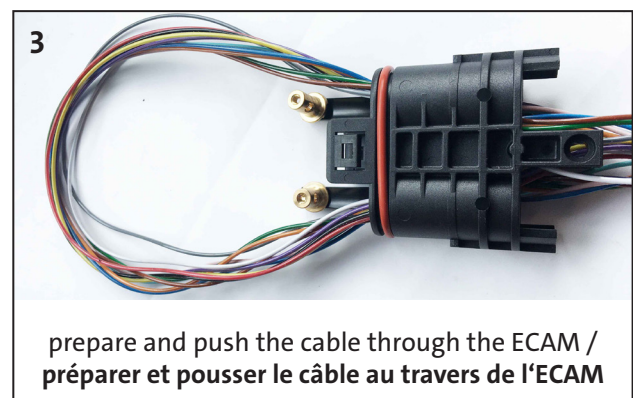
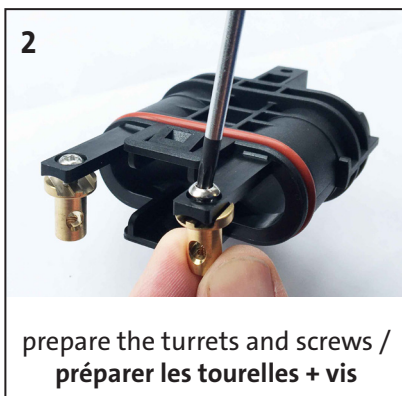
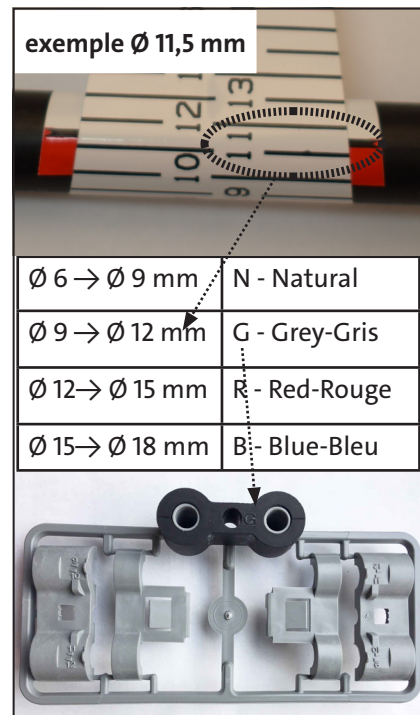
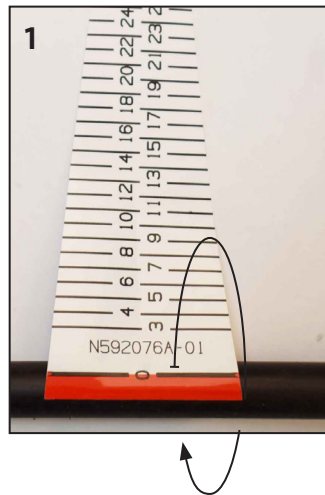

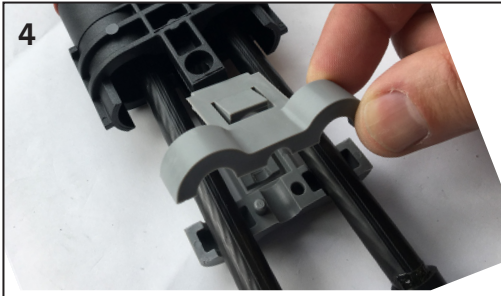

4 place and clip the upper spacers /
placer et clipper les entretoises supérieures



5 Push and press the spacers into the ECAM /
Pousser et enfoncer les entretoises dans l'ECAM

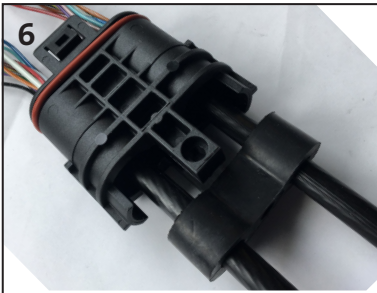

6 place the gasket /
placer la garniture

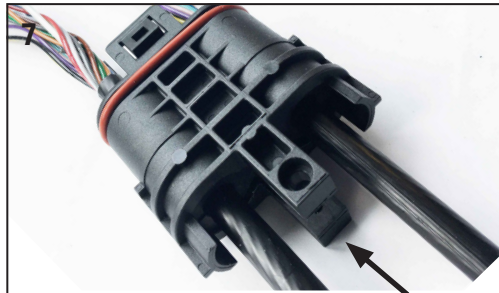

7 push the gasket into the ECAM /
pousser la garniture dans l'ECAM



8 if only one cable, use the red plug
si un seul câble, utiliser le bouchon
rouge

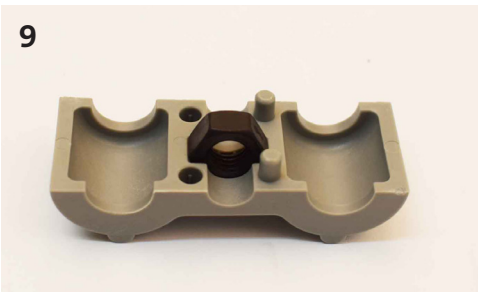

9 place the nut in the lower spacer /
placer l'écrou dans l'entretoise inférieure



10 place and clip the spacers /
placer et clipper les entretoises



11 push the spacers into the ECAM /
pousser les entretoises dans l'ECAM

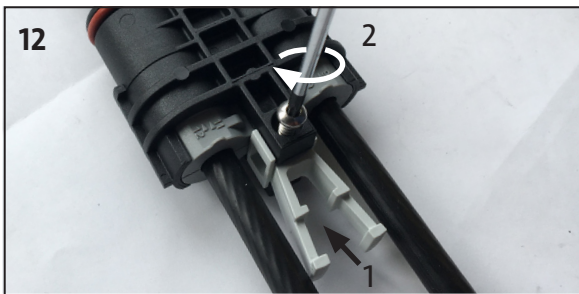

12 place and tighten the mooring support on the
body / placer et serrer la bride sur le corps

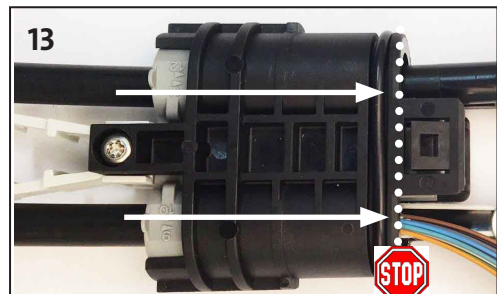

13 place the 2 cables /
positionner les 2 câbles

with meach / avec mèche aramide

14 a

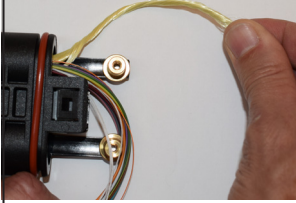

prepare
préparer

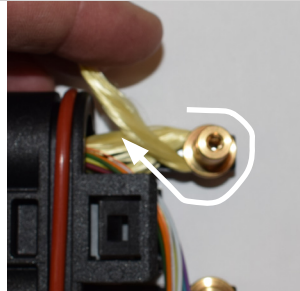

wrap
enrouler

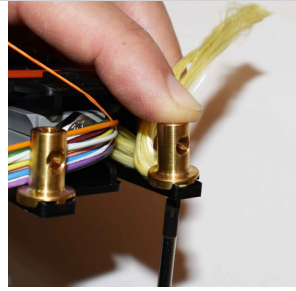

screw
visser

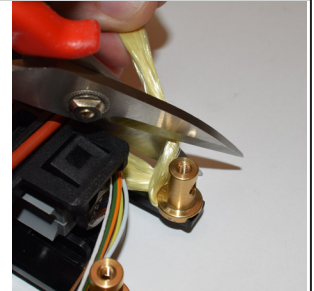

cut
couper

with 2 carriers / avec 2 porteurs

14 b

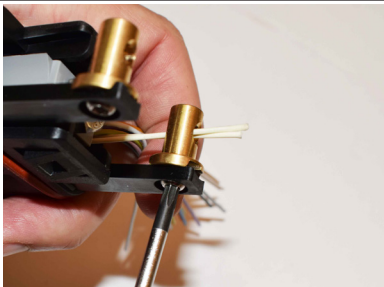

prepare and tighten
préparer et serrer

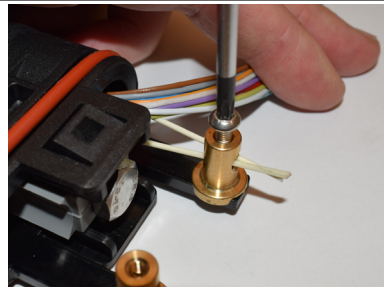

screw
visser

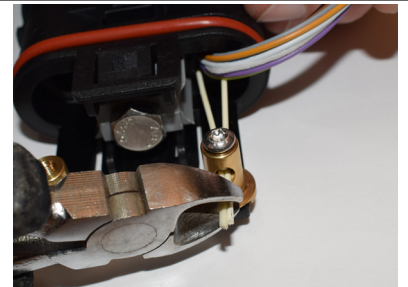

cut
couper

or / ou

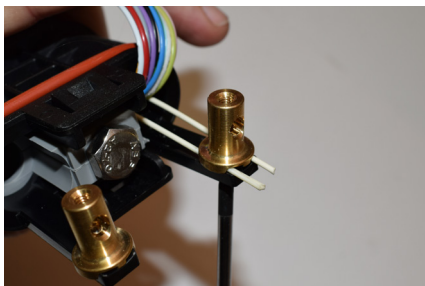

place and tighten
préparer et serrer

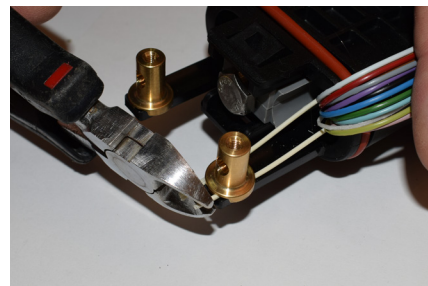

cut
couper

with 1 central carrier / avec un porteur central

14 c

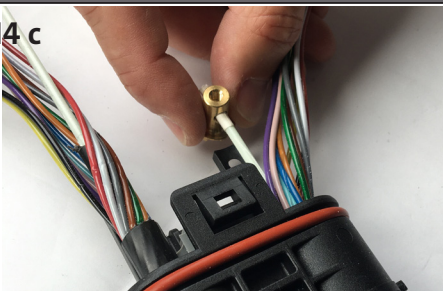

place
préparer

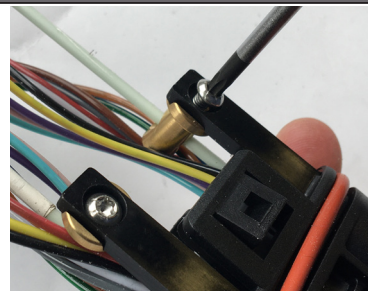

tighten
serrer

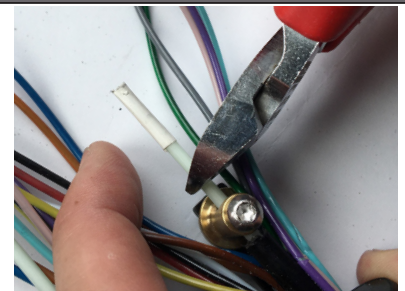

cut
couper

15

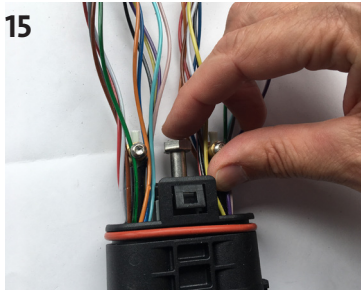

place the screw into the body
 placer la vis dans le corps

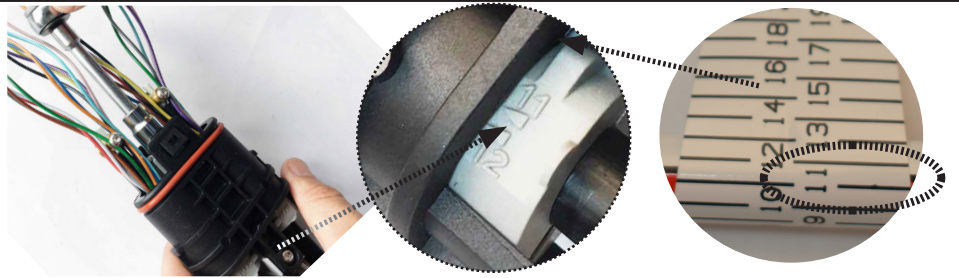

tighten the screw in the body according to the information of the \varnothing of the cable.
 In example: $\varnothing 11.5$ cable \Rightarrow tightening = tip Δ at 11
 serrer la vis dans le corps suivant les informations du \varnothing du cable.
 Dans exemple: cable $\varnothing 11,5 \Rightarrow$ serrage = pointe Δ à 11

MINI EXTEND cable

16 a



place a spiral rubber tape
 placer un joint spirale



tighten a cable tie
 serrer un collier plastique

ALTOS cable

16 b



tighten a cable tie
 serrer un collier plastique