

CableMux (4CH)

CORNING

Features and Benefits

Bi-Directional

Low Insertion Loss

Epoxy-Free Optical Path

Highly Reliable and Stable

Extended Operating Temperature Available

CableMux is a single mode fiber passive break-out cable that can pair with 40GB and 100GB LR4 and ER4 optical transceivers for data center applications. It is also a small foot print multiplexing device suitable for module integration in various Telecom and Access applications.

Standards

RoHS

Free of hazardous substances according to RoHS2011/65/EU

Design and Test Criteria

Product is qualified to Telcordia GR-1209-CORE and GR-1221-CORE

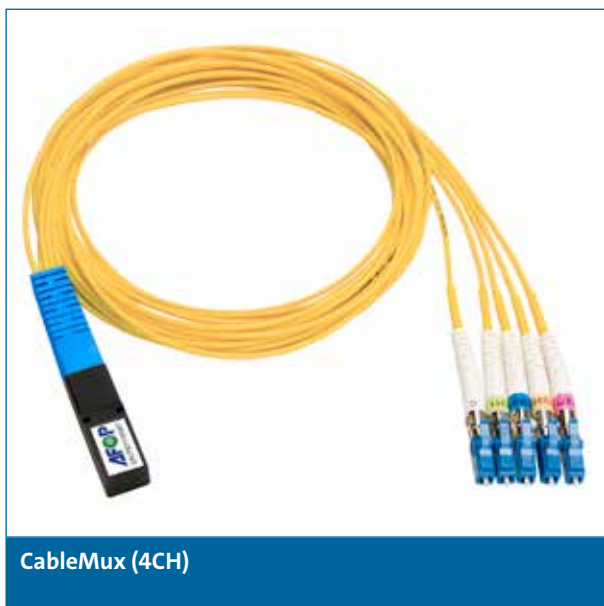

CORNING

CableMux (4CH)

CORNING

Specifications

Parameters	Minimum	Maximum
Operating Wavelength Range	1260 nm	1620 nm
Pass Bandwidth	1 +/- 7 nm	
Pass Channel Insertion Loss		1.8 dB
Passband Uniformity		1.0 dB
Passband Ripple		0.3 dB
Adjacent Channel Isolation	30 dB	
Non-adjacent Channel Isolation	45 dB	
Return Loss	45 dB	
Directivity	55 dB	
PDL		0.25 dB
PMD		0.2 ps
Optical Power		300 mW

Shipping Package		
Packaging Dimensions	Fiber Type	Pigtail Length
35 mm (L) x 11.5 mm (W) x 8.0 mm (H)	Corning® MF-28e®	1 m (Standard)

Mechanical Drawing

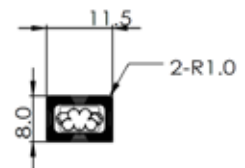
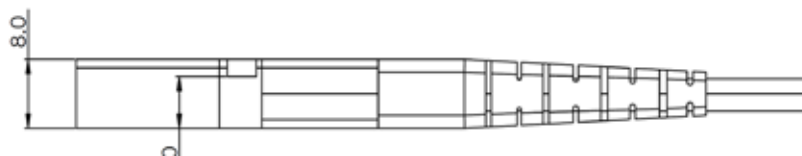
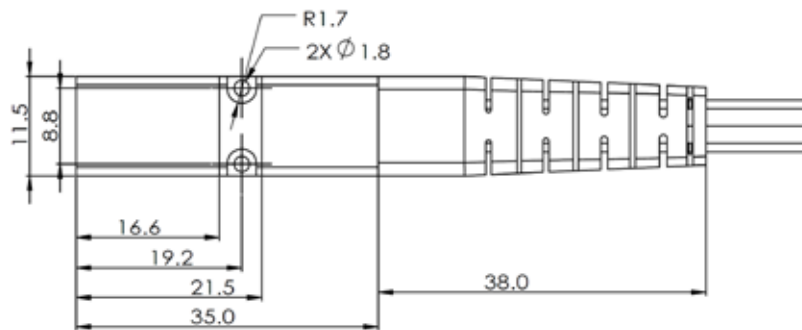

CORNING

CableMux (4CH)

CORNING

Ordering Information

CableMux (4CH)

C W 4 - B -

1 2 3 4 5 6 7

1 Select Type

- 1: Mux
- 2: DeMux

2 Select Channel Count

- 1: 4-Channel

3 Select Fiber Type

- 6: 1.6 mm Yellow Jacketed Cable

4 Select Connector*

- A: None
- L : LC/PC
- P: FC/PC
- Q: FC/APC
- S: SC/PC
- T: SC/APC
- U: MU/PC

5 Select ITU Starting Wavelength

- B: 1291 nm
- 1: 1471 nm
- 3: 1511 nm
- 5: 1551 nm
- 9: Custom

6 Select Optional Channel

- 0: No Express
- 1: With Express

7 Select Customization

- 00: Running number used for special types or custom made

Note:

* Insertion loss does not include connector loss



These part numbers are specific to Corning Optical Communications OEM Solutions Business Unit. Please contact OEM sales at +1-408-736-6900 or oemsales@corning.com and visit www.corning.com/opcomm/oem for sales support.

Corning Optical Communications LLC • PO Box 489 • Hickory, NC 28603-0489 USA

800-743-2675 • FAX: 828-325-5060 • International: +1-408-736-6900 • www.corning.com/opcomm/oem • Email: oemsales@corning.com

Corning Optical Communications reserves the right to improve, enhance, and modify the features and specifications of Corning Optical Communications products without prior notification. A complete listing of the trademarks of Corning Optical Communications is available at www.corning.com/opcomm/trademarks. All other trademarks are the properties of their respective owners. Corning Optical Communications is ISO 9001 certified.

© 2016 Corning Optical Communications. All rights reserved.

Spec Sheet CAH-151_AEN

Page 3 | Revision date 2016-12-14

CORNING